

# Meetings & Events

AT MOLINEUX STADIUM



# Introduction

**Molineux Stadium, the home of Wolverhampton Wanderers FC is now established as one of the largest conference and events venues in the Black Country.**

Molineux is not only a state of the art sports stadium – but our meeting rooms and spaces provide flexible and unique facilities for events on all scales, from a modest gathering to a corporate event for over five hundred guests.

Molineux Stadium provides convenient rail and road links with Wolverhampton Central Station just half a mile away and five miles from M6 Junction 10; it also boasts over 300 free onsite car parking spaces.







# WV1

The stunning facility in Stan Cullis Stand offers a large capacity of up to 550 people in superb comfort.

With breath-taking floor to ceiling views of the stadium and North Wolverhampton. The WV1 offers a light, airy facility with a contemporary feel that is not matched anywhere else at Molineux or indeed the whole of Wolverhampton.

The room can be divided into smaller rooms being WV1 Bar and WV1 Restaurant both with their own kitchen, Bar and toilets meaning that both facilities can accommodate separate events easily or can be used as separate drinks and dinner areas to offer a new experience for your event.

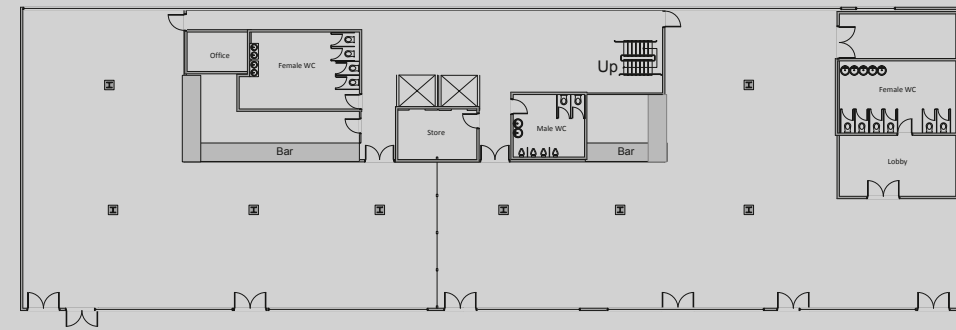

Floor Plan





## Suitability

- Conferences & Exhibitions
- Dinner & DJ
- Dinner & Speaker
- Awards ceremonies
- Meetings & Seminars
- Training
- Private Parties
- Weddings

## Facilities

- Wheelchair access
- Natural daylight
- Blackout possible
- LED Mood Lighting
- Wi-Fi
- Bar

## Layouts

-  Theatre  
553 people
-  Classroom  
160 people
-  U-Shape  
50 people
-  Boardroom  
60 people
-  Cabaret  
300 people

-  Hollow Square  
60 people
-  Cocktail  
553 people
-  Dinner  
553 people
-  Dinner Dance  
500 people



## Key specs

Area 56x20m : 1120sqm  
Max height 2.54m







# Hayward Suite

Named after the great Sir Jack Hayward, the generous benefactor of Wolves for an eventful 17 years, the Hayward Suite is an outstanding venue.

Situated in the Billy Wright Stand, the Hayward Suite offers spectacular views across Molineux Stadium and is an impressive facility to hold any event. Suitable for conferences, dinners and parties the suite can hold up to 400 guests.

The Hayward Suite can be divided into two rooms: our Molineux Suite and Executive Club. This makes it a versatile space, with views overlooking the pitch that really create the 'wow' factor for your event.

Floor Plan

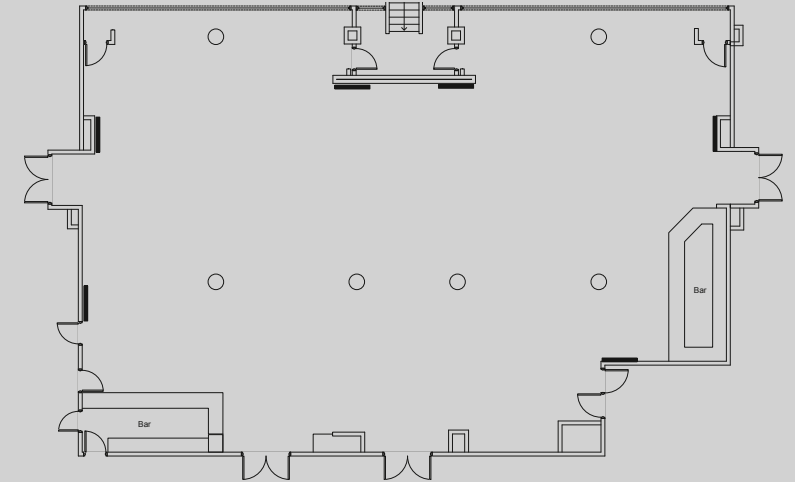









## Suitability

- Conferences & Exhibitions
- Dinner & DJ
- Dinner & Speaker
- Awards ceremonies
- Meetings & Seminars
- Training
- Private Parties
- Weddings
- Christenings

## Facilities

- Wheelchair access
- Natural daylight
- Blackout possible
- Wi-Fi
- Private Bar
- 20 x power points
- Air conditioning

## Layouts

- |   |  |
|---|--|
|  Theatre<br>400 people   |  Hollow Square<br>N/A       |
|  Classroom<br>140 people |  Cocktail<br>500 people     |
|  U-Shape<br>N/A          |  Dinner<br>300 people       |
|  Boardroom<br>80 people  |  Dinner Dance<br>250 people |
|  Cabaret<br>250 people   |  |



**Key specs**  
Area 17x25m : 425sqm  
Max height 2.54m





# International Suite

The International Suite is located in the Billy Wright Stand, which has been turned into an impressive and modern facility that can accommodate up to 140 guests.

A comfortable space with state-of-the-art LED lighting to create a mood and atmosphere to match any occasion. This is a perfect room for seminars, meetings and private dinners.

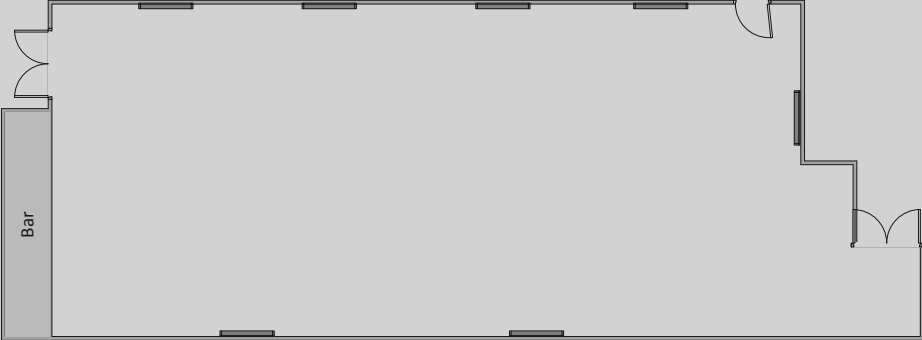

Floor Plan









## Suitability

- Dinner & DJ
- Dinner & Speaker
- Awards ceremonies
- Meetings & Seminars
- Training
- Private Parties
- Weddings
- Christenings

## Facilities

- Wheelchair access
- Natural daylight
- Air Conditioning
- Wi-Fi
- Bar
- LED mood-lighting

## Layouts

- |  |  |
|--|--|
|  Theatre<br>140 people  |  Hollow Square<br>50 people |
|  Classroom<br>40 people |  Cocktail<br>200 people     |
|  U-Shape<br>40 people   |  Dinner<br>130 people       |
|  Boardroom<br>40 people |  Dinner Dance<br>120 people |
|  Cabaret<br>120 people  |  |



**Key specs**  
Area 19.8x9.25m : 183.15sqm  
Max height 2.54m





# Media Suite

Situated in the Billy Wright Stand, our Media Suite is the bustling home of global media representatives and reporters on match days.

Use the manager's seat to address your guests and enjoy an inviting facility, which is ideal for conferences and seminars for up to 100 guests.

Floor Plan



## Suitability

- Awards ceremonies
- Meetings & Seminars
- Training

## Facilities

- Wheelchair access
- Natural daylight
- Air Conditioning
- Wi-Fi

## Layouts

 Theatre  
100 people

 Hollow Square  
38 people

 Classroom  
40 people

 Cocktail  
150 people

 U-Shape  
33 people

 Boardroom  
38 people

 Cabaret  
50 people



## Key specs

Area 14.5x9m : 130.5sqm  
Max height 2.54m



# The Boardroom

The Boardroom is the facility that services the Director's Box on a matchday.

The Boardroom is the most exclusive facility of all our hospitality suites. It is ideal for luxury corporate dining events, smaller intimate parties or cocktail/canapé receptions.

The Boardroom also lends itself perfectly to hosting meetings; seminars; networking or training sessions with its built-in LED screens, natural daylight, air conditioning and private bars.

Floor Plan

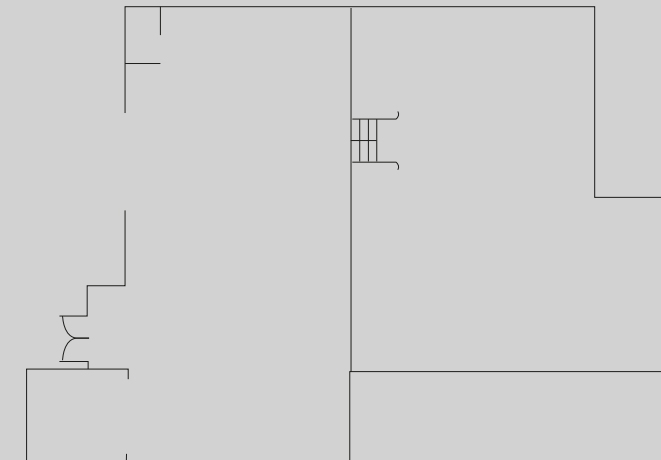







## Suitability

- Meetings & Seminars
- Private Functions
- Dinners
- Training
- Private Parties
- Conferences & Exhibitions

## Facilities

- Wheelchair access
- Wi-Fi
- Bar
- Natural Daylight
- Air Conditioning

## Layouts

- |  |  |
|--|--|
|  Theatre<br>60 people   |  Hollow Square<br>30 people |
|  Classroom<br>30 people |  Cocktail<br>120 people     |
|  U-Shape<br>20 people   |  Dinner<br>120 people       |
|  Boardroom<br>25 people |  Dinner Dance<br>80 people  |
|  Cabaret<br>50 people   |  |



## Key specs

Area 14.5x14m : 203sqm  
Max height 2.54m





# WV1 North Bank Bar

Located in the re-developed Stan Cullis Stand on the ground floor, open on matchdays, and available for private hire for drinks receptions and private parties, the bar has a relaxed atmosphere in a convenient location, which is ideal for families and supporters alike.

Floor Plan

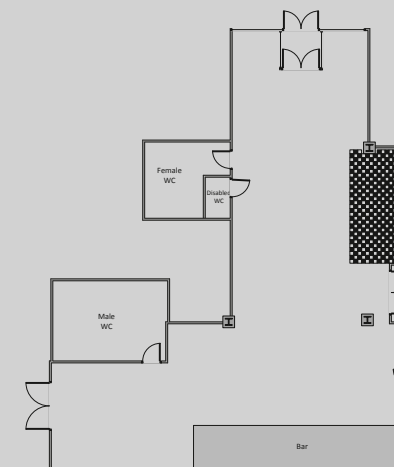









## Suitability

- Private Functions
- Party Events

## Facilities

- Wheelchair access
- Natural daylight
- Air Conditioning
- Ground floor access

## Layouts

- |  |  |
|--|--|
|  Theatre<br>180 people  |  Hollow Square<br>30 people |
|  Classroom<br>30 people |  Cocktail<br>300 people     |
|  U-Shape<br>40 people   |  Dinner<br>180 people       |
|  Boardroom<br>40 people |  Dinner Dance<br>150 people |
|  Cabaret<br>120 people  |  |



## Key specs

Area 20x18.5m : 370sqm  
Max height 2.54m





# Sir Jack's Restaurant

With such a great level of gratitude for a great man, this is the second facility at Molineux dedicated to Sir Jack Hayward.

Used to entertain Match Sponsors on matchdays and discerning diners for the rest of the week, there is not a more suitable name for an area used to entertain such a varied, and large, guest list.

Situated in the heart of Molineux Stadium, occupying a central pitch-facing position in the Billy Wright Stand, the Restaurant is an excellent venue for a dinner or lunch event for up to 70 guests.

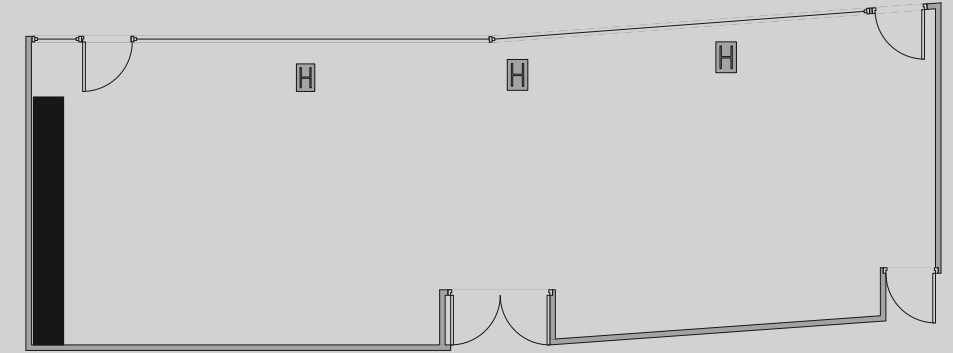

Floor Plan









## Suitability

- Private Functions
- Party Events
- Dinners
- Meetings & Seminars
- Weddings
- Christenings

## Facilities

- Wheelchair access
- Natural daylight
- Blackout possible
- Wi-Fi
- Air Conditioning

## Layouts

- |  |  |
|--|--|
|  Theatre<br>70 people   |  Hollow Square<br>24 people |
|  Classroom<br>N/A       |  Cocktail<br>85 people      |
|  U-Shape<br>18 people   |  Dinner<br>50 people        |
|  Boardroom<br>20 people |  Dinner Dance<br>N/A        |
|  Cabaret<br>48 people   |  |



## Key specs

Area 16.5x5.3m : 87.45sqm  
Max height 2.54m







# Fallowfield Lounge

The Fallowfield Lounge is an inviting room, lit by natural light from large windows overlooking Waterloo Road and the impressive Billy Wright Statue.

Ideal for small meetings and breakout groups, it is perfectly located to be used in conjunction with the Hayward Suite.

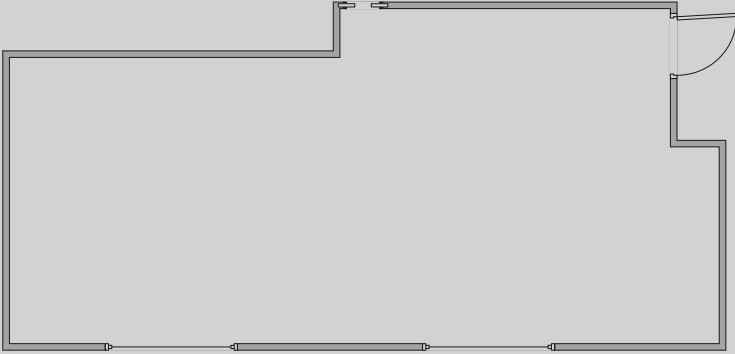

Floor Plan









## Suitability

- Meetings & Seminars
- Private functions
- Break-out room for larger event
- Training

## Facilities

- Wheelchair access
- Natural daylight
- Wi-Fi
- Air Conditioning

## Layouts

-  Theatre  
40 people
-  Classroom  
12 people
-  U-Shape  
17 people
-  Boardroom  
22 people
-  Cabaret  
30 people
-  Hollow Square  
22 people
-  Cocktail  
40 people
-  Dinner  
40 people
-  Dinner Dance  
30 people



**Key specs**  
Area 10x4.5m : 45sqm  
Max height 2.54m





# Billy's Boot Room

Billy's Boot Room is dedicated to the great legend of English Football, Billy Wright CBE.

Wright became a hero of Wolverhampton as well as the rest of the country due to his outstanding football career that still sees him the third most capped player in English football.

The Boot Room is an intimate facility that can accommodate up to 32 guests and is ideal for smaller meetings or as a separate bar area when enjoying the amenities offered elsewhere in the Stadium.

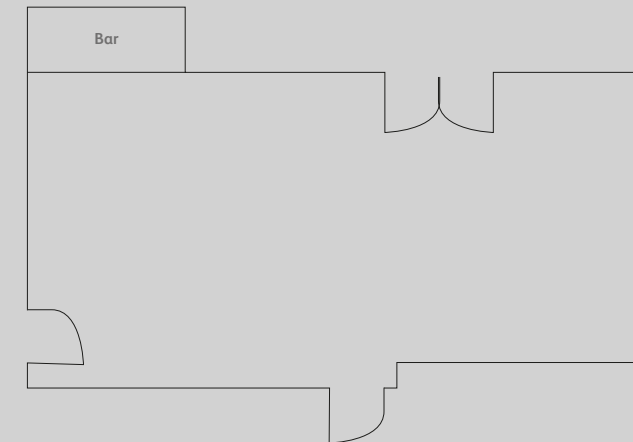

Floor Plan









## Suitability

- Meetings & Seminars
- Private functions
- Break-out room for larger event

## Facilities

- Wheelchair access
- Natural daylight
- Wi-Fi
- Bar
- Air Conditioning

## Layouts

- |  |  |
|--|--|
|  Theatre<br>25 people   |  Hollow Square<br>20 people |
|  Classroom<br>16 people |  Cocktail<br>50 people      |
|  U-Shape<br>15 people   |  Dinner<br>30 people        |
|  Boardroom<br>15 people |  Dinner Dance<br>N/A        |
|  Cabaret<br>30 people   |  |



## Key specs

Area 9x5.2m : 46.8sqm  
Max height 2.54m



# Chairman's Suite

Recently-refurbished the chairman's suite is one of the most advanced rooms at Molineux, with a video wall, built in PA System and natural daylight.

Perfect for a more relaxed, intimate environment ideal for meetings, private dining, training courses, board meetings and breakout groups, it is perfectly located to be used in conjunction with the Boardroom.

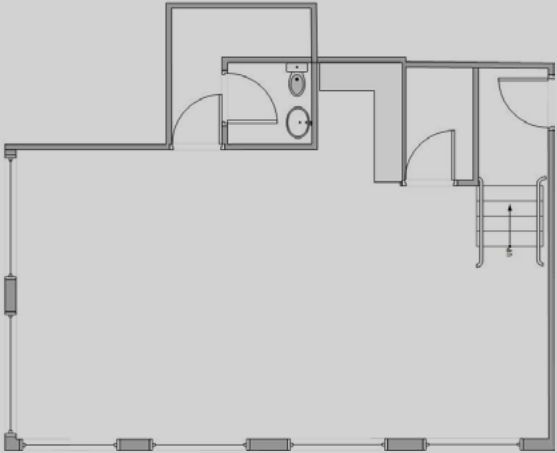









## Suitability

- Meetings & Seminars
- Private functions
- Break-out room for larger event
- Dinners
- Training
- Private Parties

## Facilities

- Natural daylight
- Wi-Fi
- Video wall
- Air Conditioning

## Layouts

- |  |  |
|--|--|
|  Theatre<br>40 people   |  Hollow Square<br>12 people |
|  Classroom<br>12 people |  Cocktail<br>30 people      |
|  U-Shape<br>18 people   |  Dinner<br>30 people        |
|  Boardroom<br>22 people |  Dinner Dance<br>N/A        |
|  Cabaret<br>24 people   |  |



**Key specs**  
Area 8.8x5.7m : 50.16sqm  
Max height 2.54m





# WV1 Quadrant

A private corner suite overlooking Molineux pitch and Billy Wright Stand which is ideal for business or private hire for small functions, it is perfectly located to be used in conjunction with the WV1.

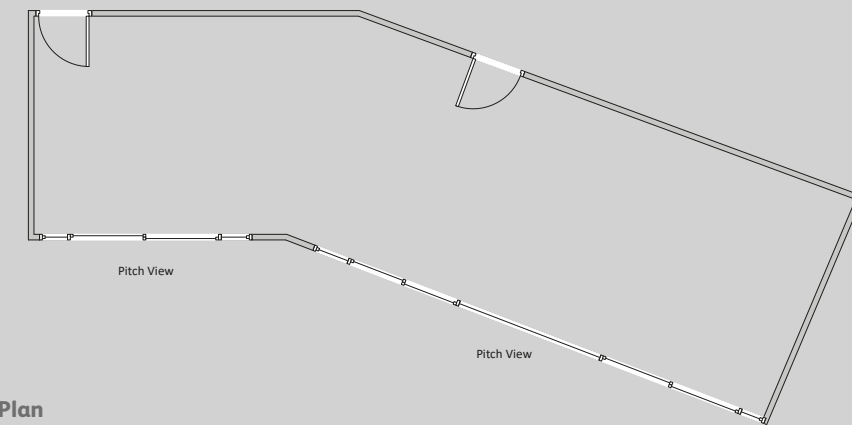

Floor Plan









## Suitability

- Meetings & Seminars
- Private functions
- Break-out room for larger event
- Training

## Facilities

- Wheelchair access
- Natural daylight
- Wi-Fi
- Air Conditioning

## Layouts

 Theatre 32 people	 Hollow Square 20 people
 Classroom 16 people	 Cocktail 32 people
 U-Shape 18 people	 Dinner 32 people
 Boardroom 24 people	 Dinner Dance 20 people
 Cabaret 30 people	



## Key specs

Area 14x4m max : 56sqm  
Max height 2.54m



# Executive Boxes

Executive Boxes are individual rooms located in the Billy Wright Stand. There are 18 in total, each offering fantastic views across Molineux Stadium.

Catering for parties from two to twenty guests they are ideal for private meetings or dinners and breakout rooms for larger events held in other facilities.

Each has its own balcony with seating giving your guests a chance to sample the atmosphere of Molineux, which even without a match is still palpable.

Floor Plan

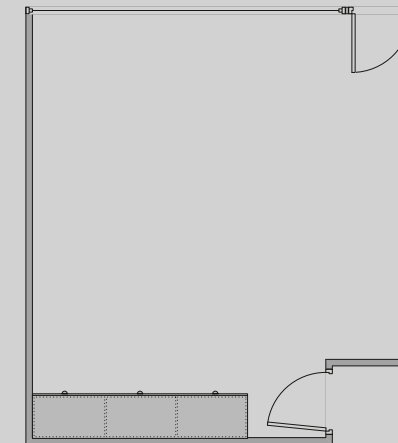









## Suitability

- Meetings & Seminars
- Private functions

## Facilities

- Wheelchair access
- Natural daylight
- Wi-Fi
- Air Conditioning

## Layouts

 Theatre 10/20 people	 Hollow Square 10/14 people
 Classroom 12 people*	 Cocktail 15/30 people
 U-Shape 8/12 people	 Dinner 8/16 people
 Boardroom 1/14 people	 Dinner Dance N/A
 Cabaret 16 people*	

\*Only in larger boxes



## Key specs

MIN Area 5.5x3.8m : 20.9sqm  
MAX Area 5.3x5.8m : 30.74sqm  
Max height 2.54m





# Wolves Museum

One of our most unusual facilities, we are lucky enough to have one of the few dedicated football club Museums in the country.

Including interactive state-of-the-art attractions, vast amounts of memorabilia and historical artefacts and a dedicated cinema room.

The Museum also has a breakout room suitable for up to 20 people and makes an ideal location for a small party or meeting with the add-on of your guests being able to enjoy a tour of the Museum.

If you are holding an event in another facility we can also arrange for the Museum to be made available to your guests to break up your day.



## Suitability

- Private functions
- Meetings
- Training
- Receptions

## Facilities

- Wheelchair access
- Access to the Museum
- Wi-Fi
- Air Conditioning







## Day Delegate Package

We can offer an all-inclusive meeting and event package for delegate numbers of 8 or above.

Day Delegate Package Includes: -

- Three servings of Freshly Brewed Tea & Coffee
- Two-course Hot Fork / Finger Buffet Selector with Chef's Dessert of the Day
- Unlimited water & Cordials
- LCD Data Projector & Screen
- Free Wi-fi
- Flipchart, Pad & Pens
- Notepaper, Pencils & Tent Cards
- Room Hire
- Free Car Parking
- Mints







**Birmingham International Airport**  
(31 miles)

**East Midlands International Airport**  
(50 miles away)

**Sat Nav**  
WV1 4QR

**M6 JCT 10**  
(5.7 miles away)

**M54 JCT 2**  
(3.8 miles away)

**Wolverhampton Station**  
(0.5 miles away)

## Getting to Molineux



### BY AIR:

If you are travelling to the Molineux from abroad then we salute your commitment!

Birmingham Airport is our nearest airport just 25 miles from Wolverhampton and is easy to get to by most forms of transport. The quickest and cheapest way to get from the airport to Molineux Stadium is via train which runs between the airport and Wolverhampton Railway Station every 30 minutes during the day. The journey takes less than 30 minutes and costs about £5 for an adult single.



### BY CAR:

If you are travelling to the Molineux from abroad then we salute your commitment! Birmingham

Airport is our nearest airport just 25 miles from Wolverhampton and is easy to get to by most forms of transport. The quickest and cheapest way to get from the airport to Molineux Stadium is via train which runs between the airport and Wolverhampton Railway Station every 30 minutes during the day. The journey takes less than 30 minutes and costs about £5 for an adult single.

## Parking

### Car Parks

- 1: Billy Wright Stand Slope
- 2: Directors Car Park
- 3: Waterloo Road Car Park
- 4: Stan Cullis Stand Car Park
- 5: Whitmore Hill Car Park



Official car park spaces start from £5 and can be booked from Wolves Ticket Office on **0371 222 1877**.



**By road from the north:**  
Exit M6 at junction 12. At island take third exit onto A5 for Wolverhampton. At the next island turn left onto A449. After six miles the A449 passes under the M54. Carry straight on and at the sixth island (Five Ways) take the third exit onto Waterloo Road. Molineux is one mile straight on.



**By road from the south west:**  
Exit M5 at junction 2. Follow the signs for Wolverhampton on the A4123 for eight miles to the Ring Road. Turn left on Ring Road, following signs for Molineux. Take second exit at next two islands, pass Banks's Brewery and swimming baths on left and then turn left at next set of traffic lights. Molineux is 500 yards on the right.



**By road from the south east:**  
Exit M6 at junction 10. Take A454 via Willenhall to Wolverhampton Ring Road. At first Ring Road island, take the fourth exit (A449 to Stafford). Straight on at next two sets of traffic lights. Filter right at third set of lights into Waterloo Road. Molineux is 500 yards on the right.

